

Empower™ BOOST Box Contents*

BOOST Sound Amplifier (left, right or pair)
Standard Vented Tip (attached to tubing)
Power Tip Large (to be used if more volume is required)
Package of Size 10 Batteries (yellow tab)
Cleaning Wire (with magnet & brush)
Carrying Case

*Exact contents are determined by quantities ordered.



Step 1: Insert battery

Remove yellow tab from a size 10 zinc-air battery. To increase battery life, wait one minute to allow battery to fully charge before inserting battery.

Gently open battery door with the control switch facing right. Insert battery positive side (flat side) up. Carefully close battery door. If there is resistance closing door, the negative side of battery may be up.

The BOOST power is controlled by opening and closing the battery door. Once the door is closed, your BOOST will begin to amplify sound and whistle.

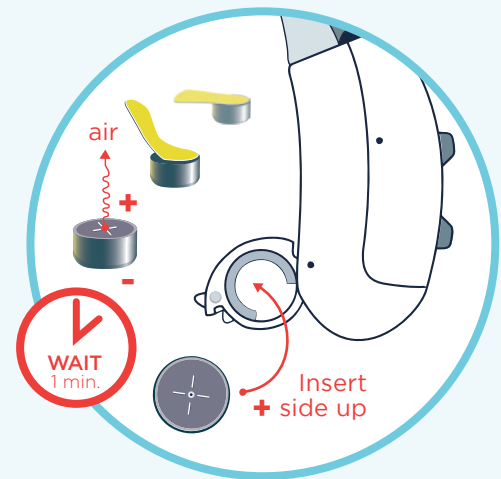

Step 2: Lower volume

Press and quickly release the bottom of the control switch several times or until whistling stops. Volume may be set at full volume upon arrival.

Hint: Partially close battery door until your BOOST is securely in your ear. Then completely close door to turn on.

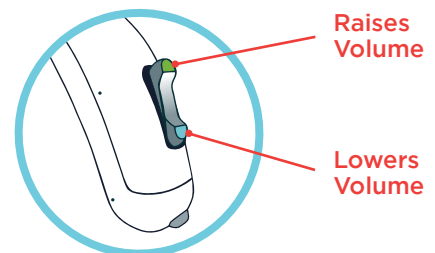

Step 3: Place tip in entrance of ear canal

Important: Verify tip is pushed all the way on tubing before inserting tip in ear. The end of tubing should be visible through the opening of tip. *Otherwise, tube may detach from tip upon removal.*

Hold tubing and back of tip (index finger inside tip and thumb on outside). Gently place tip in entrance of ear canal. The wider back of tip will form a seal outside of entrance to prevent amplified sounds from leaving ear.

Hint: The tapered design of tip accommodates majority of ear canal sizes. Smaller diameter canals will have less of tip inside canal entrance. Tips are right and left specific; they curve towards back of head.



Pulling up on top of ear allows your canal to open slightly to ease tip into entrance.

Step 4: Place BOOST behind ear

Lift body of BOOST over top of ear. If necessary, use other hand to hold over tip to secure in place.

Move ear lock into bowl of ear. It may be trimmed if it is too long for the size of ear.

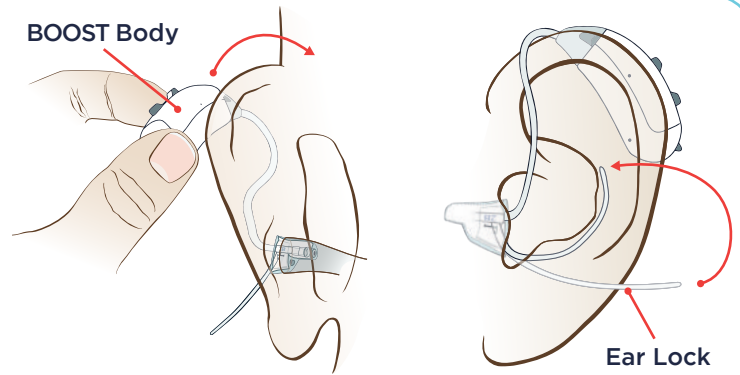

BOOST Care: Tubing and tips need to be replaced every three months for optimal performance.

To remove tubing:

Rotate tubing 90° and pull off.

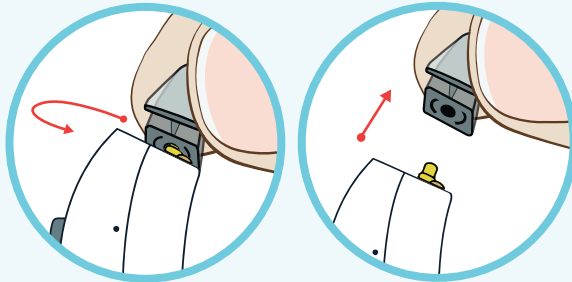

To attach tubing:

Push new tubing straight on.

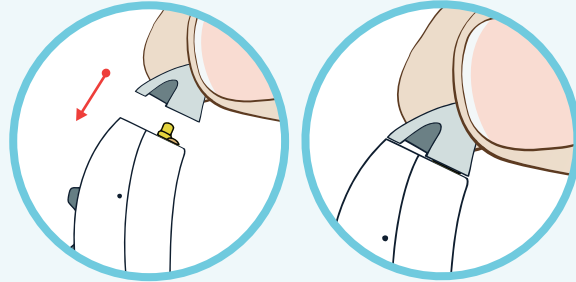

To remove tip:

Pinch front of tip and pull straight off tubing.

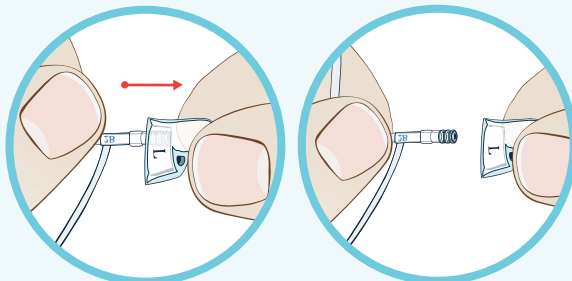

To attach tip: Align new tip so vented end is lined up with ear lock. Push tip over tubing ridges until you feel tubing flush with opening of tip.

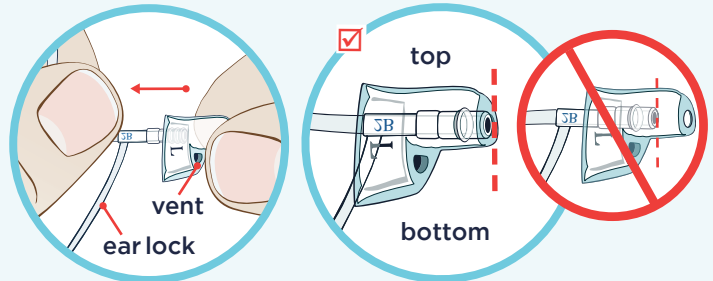



Replacement Tubes, Tips and Domes

Tube Length:

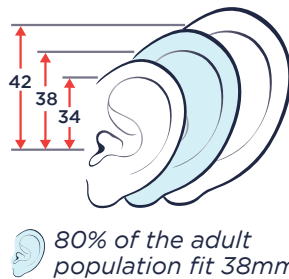
LONG — 42mm (3B)
STANDARD — 38mm (2B)
SHORT — 34mm (1B)



Tube Configuration:

RIGHT EAR — 
LEFT EAR — 

	Average Ear Canal	Large Ear Canal	Variety Pack
Natural Sound	included Vented Tip Standard	Vented Tip Large	Circular Domes Open
Maximum Output	Power Tip Standard	included Power Tip Large	Circular Domes Closed

All sizes of tubes, tips and domes are available at EmpowerHearing.com

EMPOWER™ BOOST

www.EmpowerHearing.com

support@EmpowerHearing.com